

FULL RACK

FR47(PR-T)

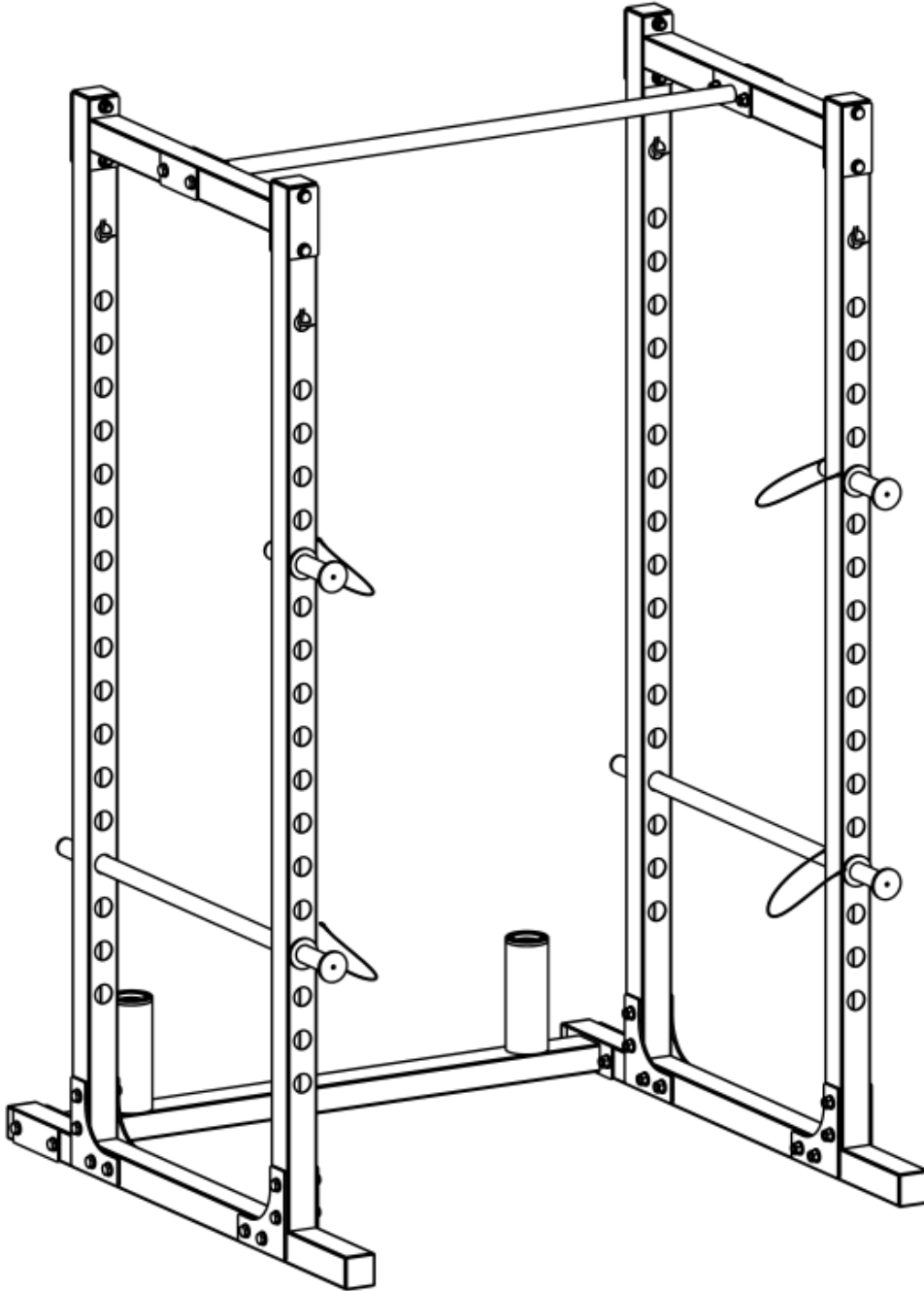

EXPLODED DRAWING& PARTS LIST

PARTS LIST

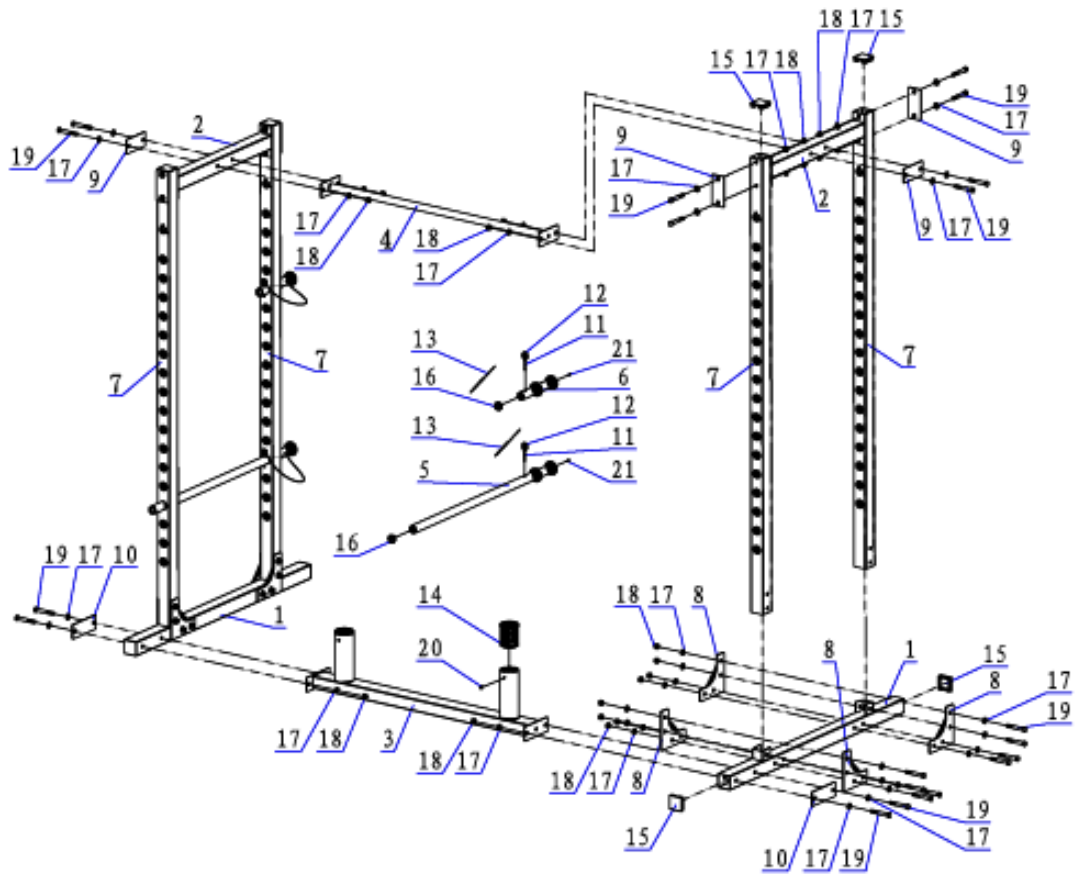

Part No.	Description	Q'ty	Part No.	Description	Q'ty
1	Base frame	2	12	Ring $\Phi 1.5 \times 31$	4
2	Side Connect Frame	2	13	Steel Cable $\Phi 5.5 \times \Phi 1.6 \times 330$	4
3	Lower Connect Frame	1	14	Barbell Sleeve	2
4	Up Connect Frame	1	15	Plug F60*2	8
5	Long Safety Bar	2	16	Plug $\Phi 32 \times 2.5$	4
6	Short Safety Bar	2	17	Flat Washer $\Phi 13.5 \times \Phi 24 \times 2.5$	64
7	Main Tube	4	18	Nut M12	32
8	L Connector Plate	8	19	Hex Bolt M12*85	32
9	Connector Plate 130*60	6	20	Hex Bolt M6*10	2
10	Connector Plate 130*60	2	21	Rivet	4
11	PIN	4			

ASSEMBLY STEP

Note: Before starting assembly remove all parts and hardware from the carton, ensure you have everything according to the list.

Step 1

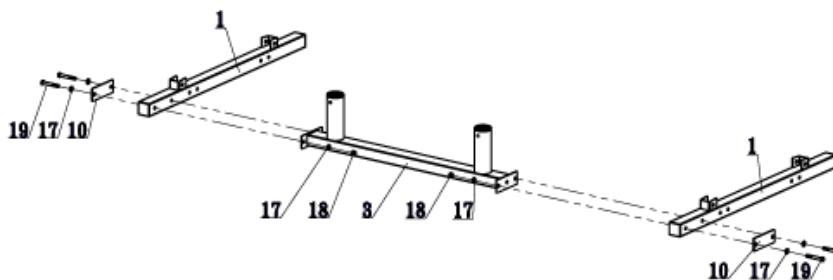

Please install the Lower Connect Frame (3) to the Base frame (1), using Connector Plate 130*60(10), Flat Washer $\Phi 13.5 \times \Phi 24 \times 2.5$ (17), Nut M12(18), Hex Bolt M12*85(19)

Step 2

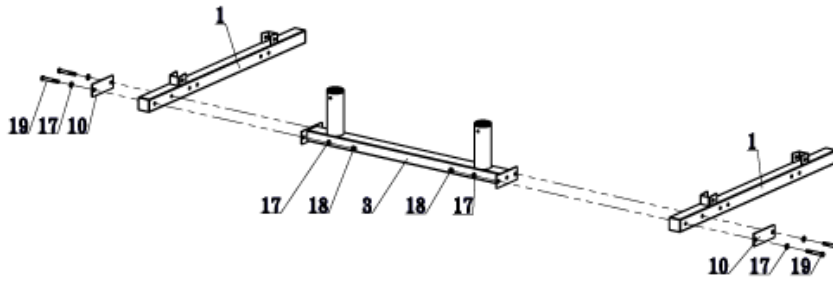

Fix the Main Tube(7) to Base Frame(1), Using L Connector Plate 130*60(8), Flat Washer $\Phi 13.5*\Phi 24*2.5$ (17), Nut M12(18), Hex Bolt M12*85(19)

Step 3

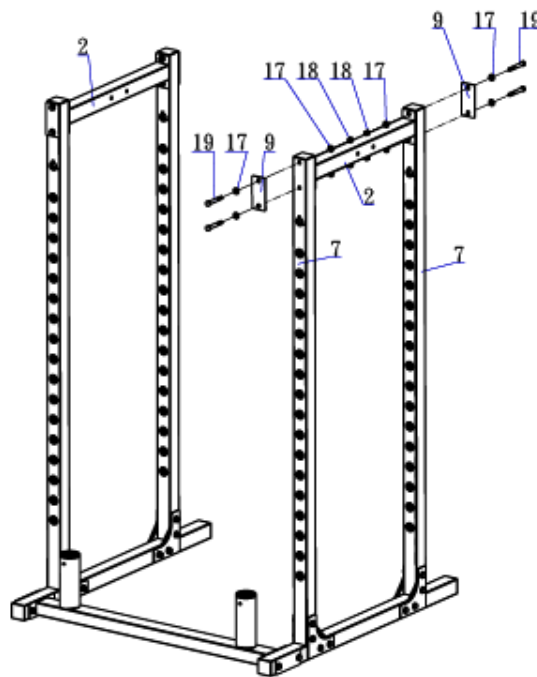

Fix the Main Tube(7) to Side Connect Frame (2), Using Connector Plate 130*60 (9), Flat Washer $\Phi 13.5*\Phi 24*2.5$ (17), Nut M12(18), Hex Bolt M12*85(19)

Step 4

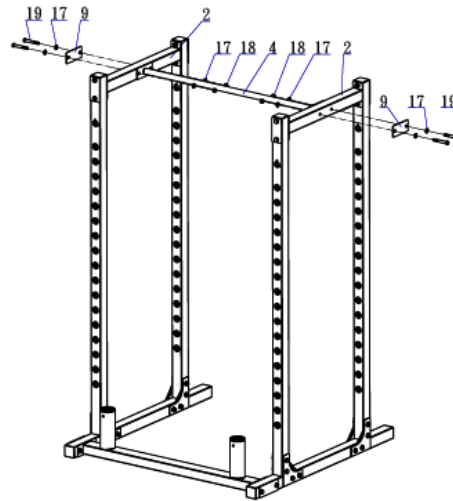

Attach Up Connect Frame (4) to Side Connect Frame (2), Using Connector Plate 130*60 (9), Flat Washer $\Phi 13.5 \times \Phi 24 \times 2.5$ (17), Nut M12(18), Hex Bolt M12*85(19)

Step 5

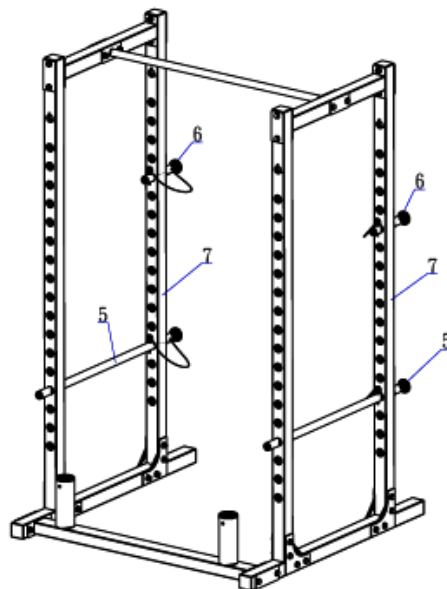

Assembly Long Safety Bar(5) and Long Safety Bar(6)

Please tighten all the nuts and bolts using wrenches.