

GLUTE HAM DEVELOPER

GHD-51W

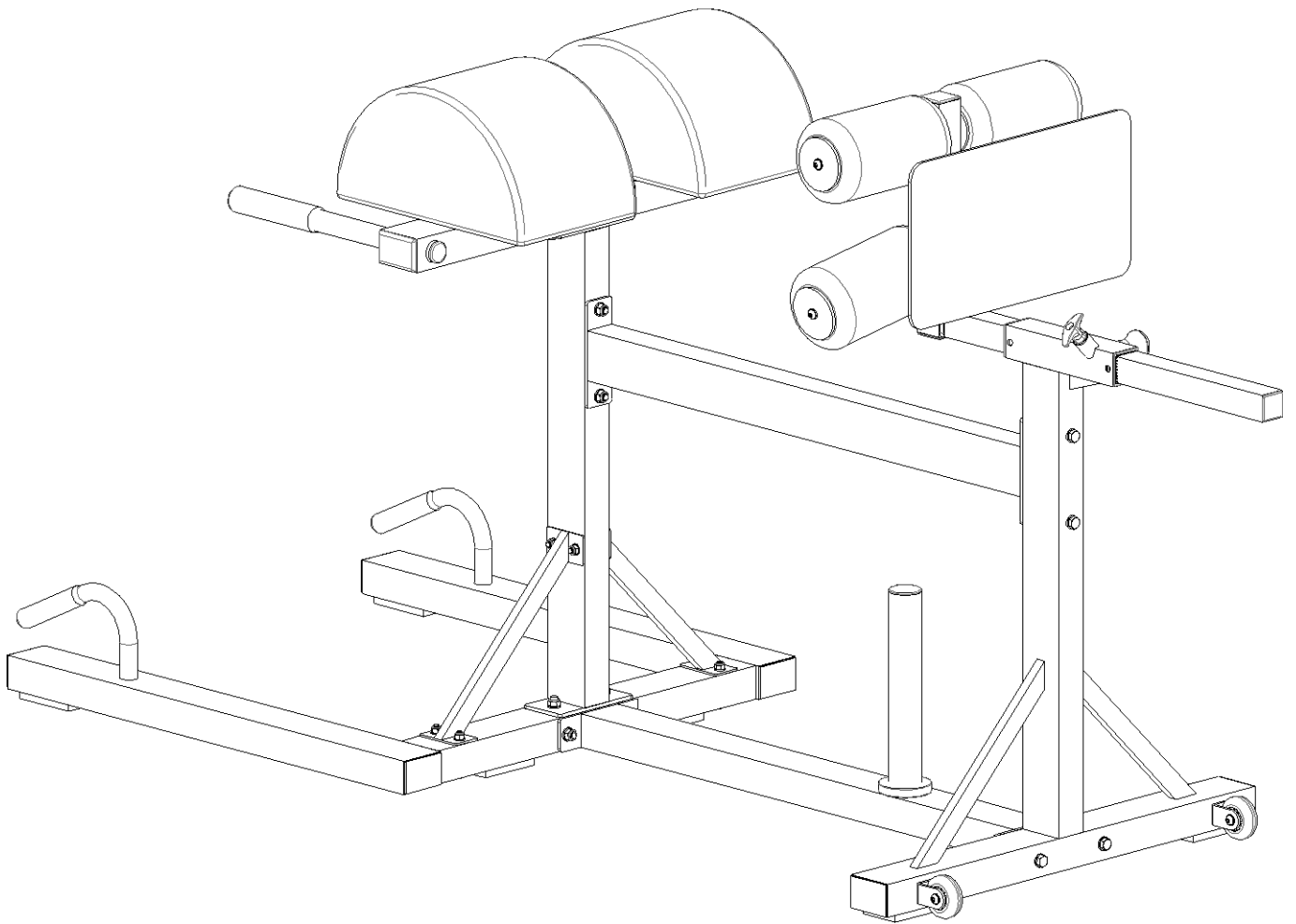

EXPLODED DRAWING

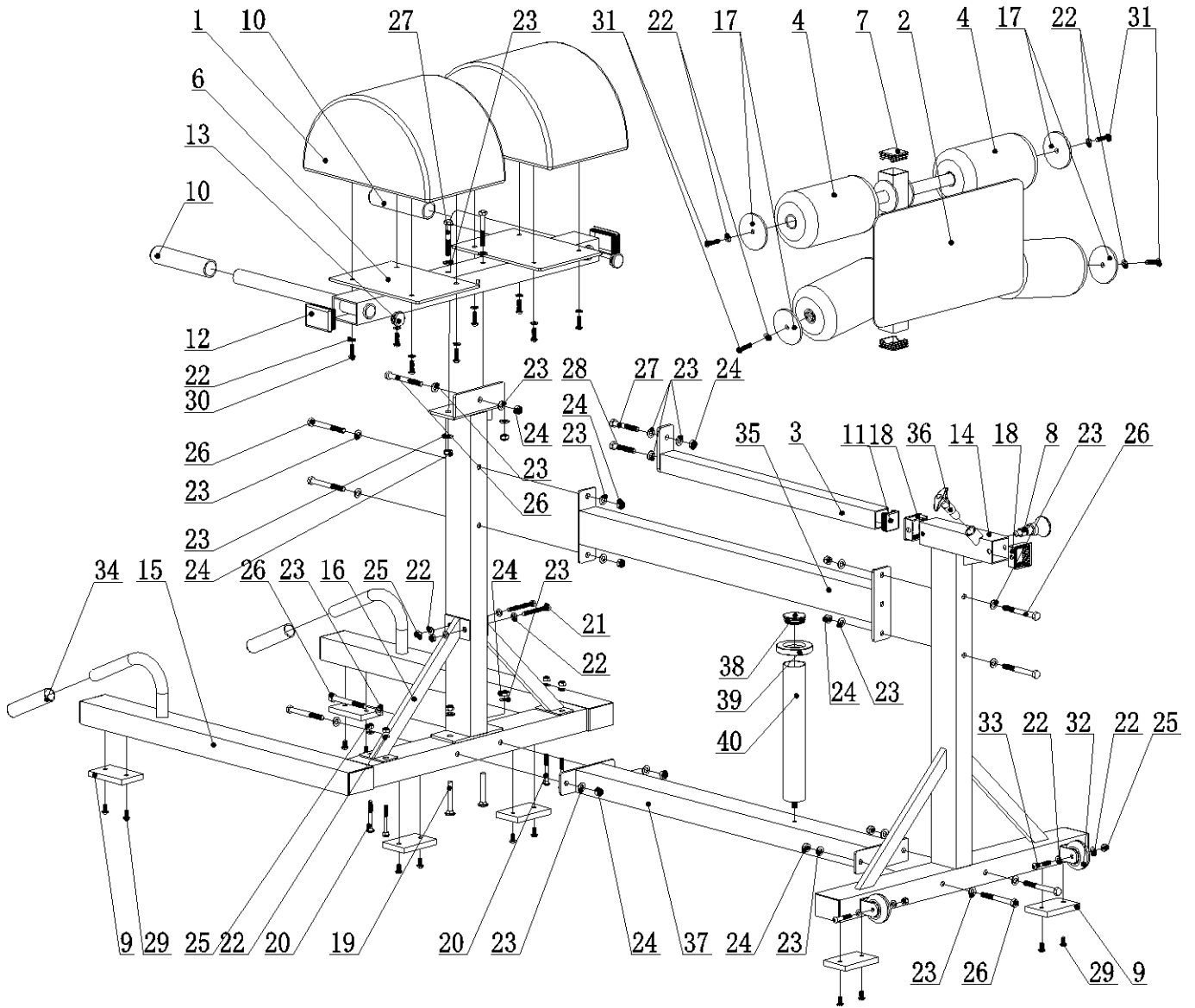

PARTS LIST

No.	Description	Qty	No.	Description	Qty
1	Semicircular Foam	2	21	Allen Bolt M8*70	2
2	Small Adjust Assembly	1	22	Flat WasherΦ9*Φ16*1.6	24
3	Slip Adjust Bar Assembly	1	23	Flat WasherΦ11*Φ20*2	27
4	Foams for foot	4	24	Nut M10	14
5	Front Support Frame	1	25	Nut M8	8
6	Foam Fixate Assembly	1	26	Allen Bolt M10*95	9
7	End Cap 45*2mm	2	27	Allen Bolt M10*70	3
8	Knob	1	28	Allen Bolt M10*60	1
9	Under Cushion 100*65*12	6	29	Allen Bolt M8*15	12
10	Handlebar Cover	2	30	Allen Bolt M8*25	8
11	End Cap 40mm	1	31	Allen Bolt M8*35	4
12	End Cap 50*75*3mm	2	32	Wheel Φ63*24	2
13	End CapΦ32*3	2	33	Allen Bolt M8*45	2
14	Big Adjust Assembly	1	34	Handle Bar Cover	2
15	Front Under Frame	1	35	Cross Frame	1
16	Side Support Bar	2	36	Lock Knob	1
17	Foam Baffle	4	37	Under Cross Frame	1
18	Sleeve 50*2-40mm	2	38	End Cap Φ48*2	1
19	Carriage Bolt M10*70	2	39	Rubber Bumper Φ77*Φ47.5*13	1
20	Carriage Bolt M8*65	4	40	Bar Holder	1

ASSEMBLY

STEP 1

Assemble big adjust assembly (14), front under frame (15) and Cross Frame (37) using Flat Washer $\Phi 11 \times \Phi 20 \times 2$ (23), Nut M10 (24) and Allen Bolt M10*95 (26), please don't tighten Nut M10 (24) in this step; Install Bar Holder (40) to Cross Frame (37).

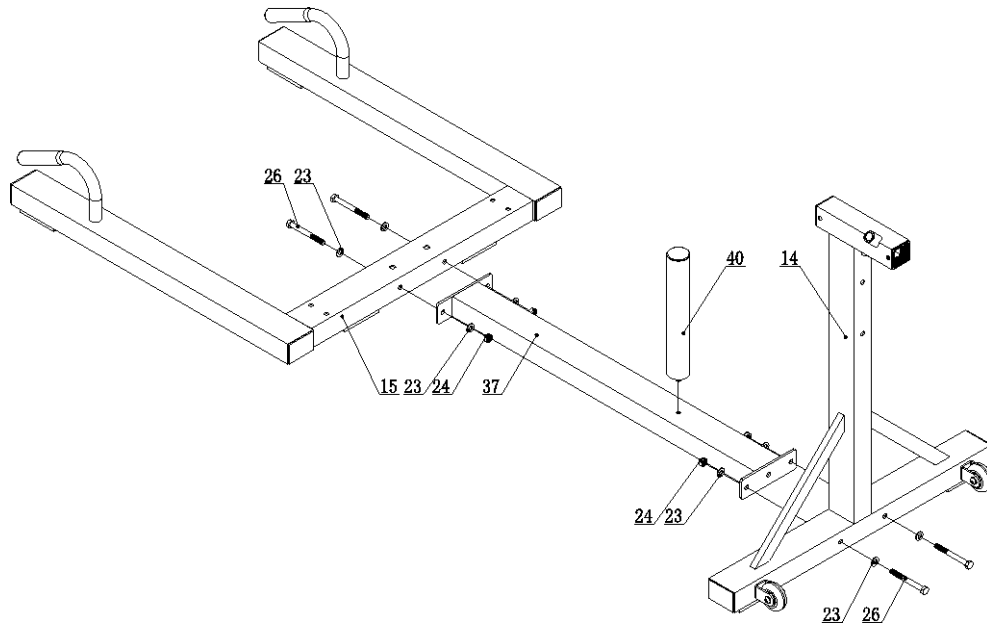

STEP 2

Install Front Support Frame (5) to Front under Frame (15) using Carriage Bolt M10*70 (19), Flat Washer $\Phi 11 \times \Phi 20 \times 2$ (23) and Nut M10 (24); Assemble front support frame (5), Big Adjust Assembly (14) and Cross Frame (35) using Flat Washer $\Phi 11 \times \Phi 20 \times 2$ (23), Nut M10 (24) and Allen Bolt M10*95 (26).

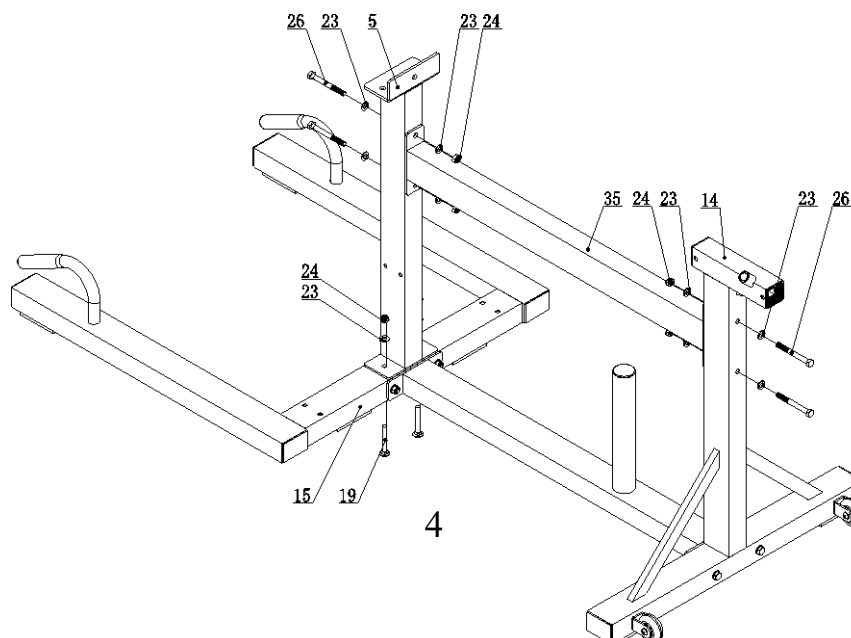

STEP 3

Install Side Support Bar (16) to Front Support Frame (5) and Front under Frame (15) using Carriage Bolt M8*65 (20), Allen Bolt M8*70(21), flat washer $\Phi 9*\Phi 16*1.6$ (22) and nut M8 (25).

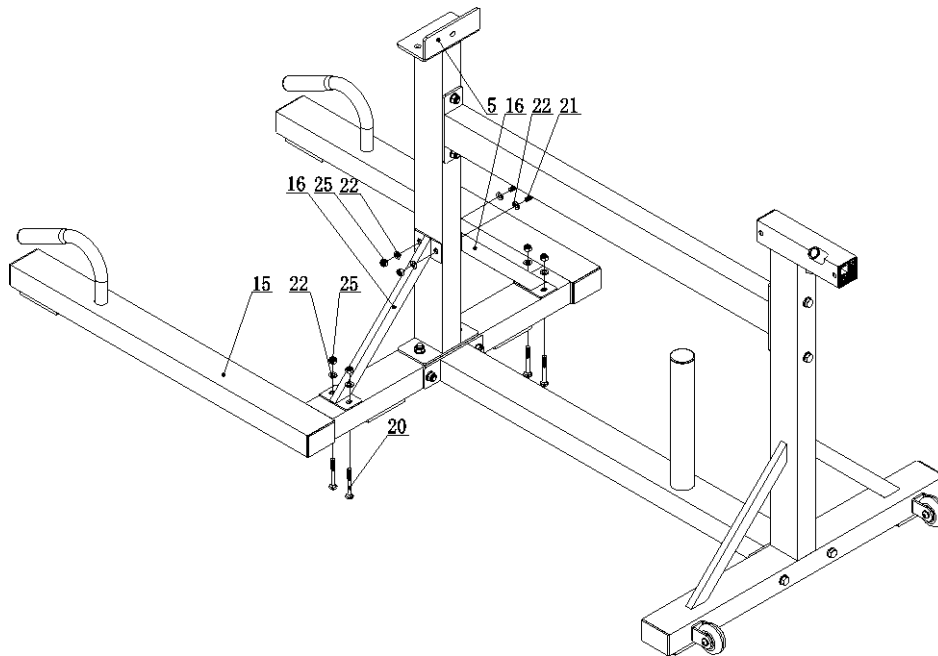

STEP 4

Install foam fixate assembly (6) to front support frame (5) as showed using flat washer $\Phi 11*\Phi 20*2$ (23), nut M10 (24), Allen bolt M10*95(26) and Allen bolt M10*70(27).

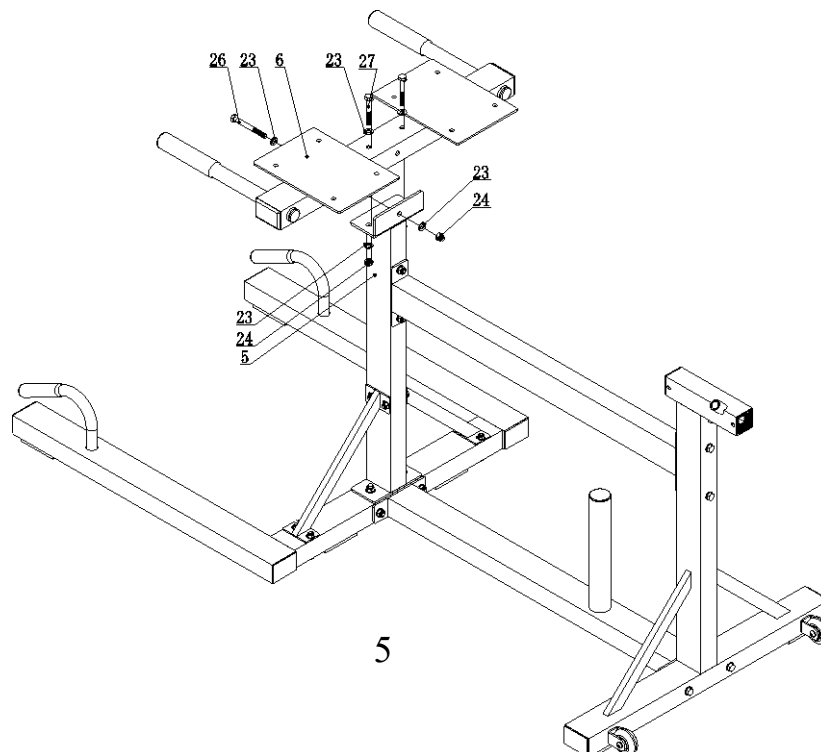

STEP 5

Install semicircular foam (1) to foam fixate assembly (6) using Flat Washer $\Phi 9 \times \Phi 16 \times 1.6$ (22) and Allen bolt M8*25 (30).

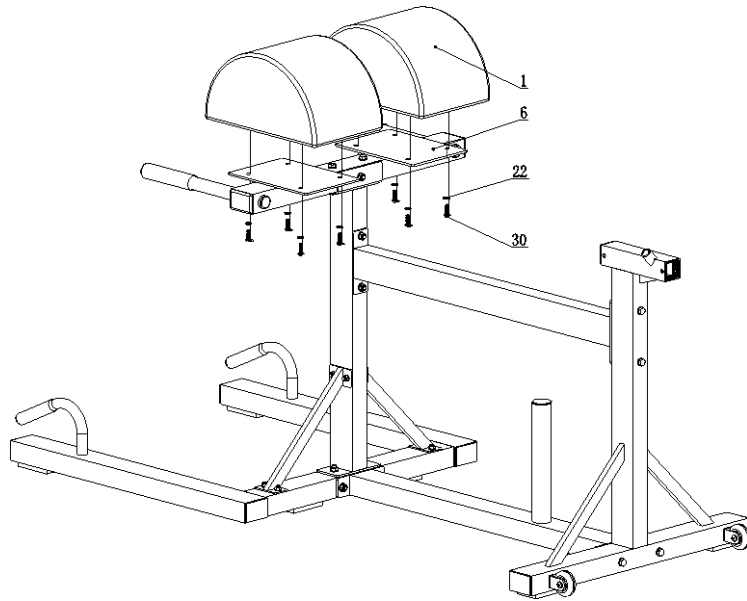

STEP 6

Connect small adjust assembly(2) and slip adjust bar assembly(3) using flat washer $\Phi 11 \times \Phi 20 \times 2$ (23), Nut M10(24), Allen bolt M10*70(27) and Allen bolt M10*60(28); Insert Slip Adjust Bar Assembly (3) into Big Adjust Assembly(14), then install Knob (8) and Lock Knob (36) to big adjust assembly (14) as show.

Please tighten all the bolts.

